



Canada Place Pavilion
Toronto, Ontario

Size: 1848 square feet
Start Date: June 3, 2002
Occupied Date: September 27, 2002

Project Information:

This modular building consists of 3 modules with 30'0" clear spanning beams to provide a 1300 sf Public Hall Area for computer research terminals.

The exterior wall is finished with metallic steel siding providing a modern high tech appeal while the stone veneer finish grounds the building to the natural site surroundings. Two of the exterior walls are finished with full height seamless glazing to create a feeling of transparency. This allows for the interior occupants to have interaction with the outside Artist Venues and at the same time draw the public inside the Pavilion.

The floor system is of steel and prepoured concrete construction, completed at NRB. This type of construction provides for a permanent modular building but also allows for the building to be moved at a future time, should the need arise.



NRB
Modular Buildings.
Ready when you are.

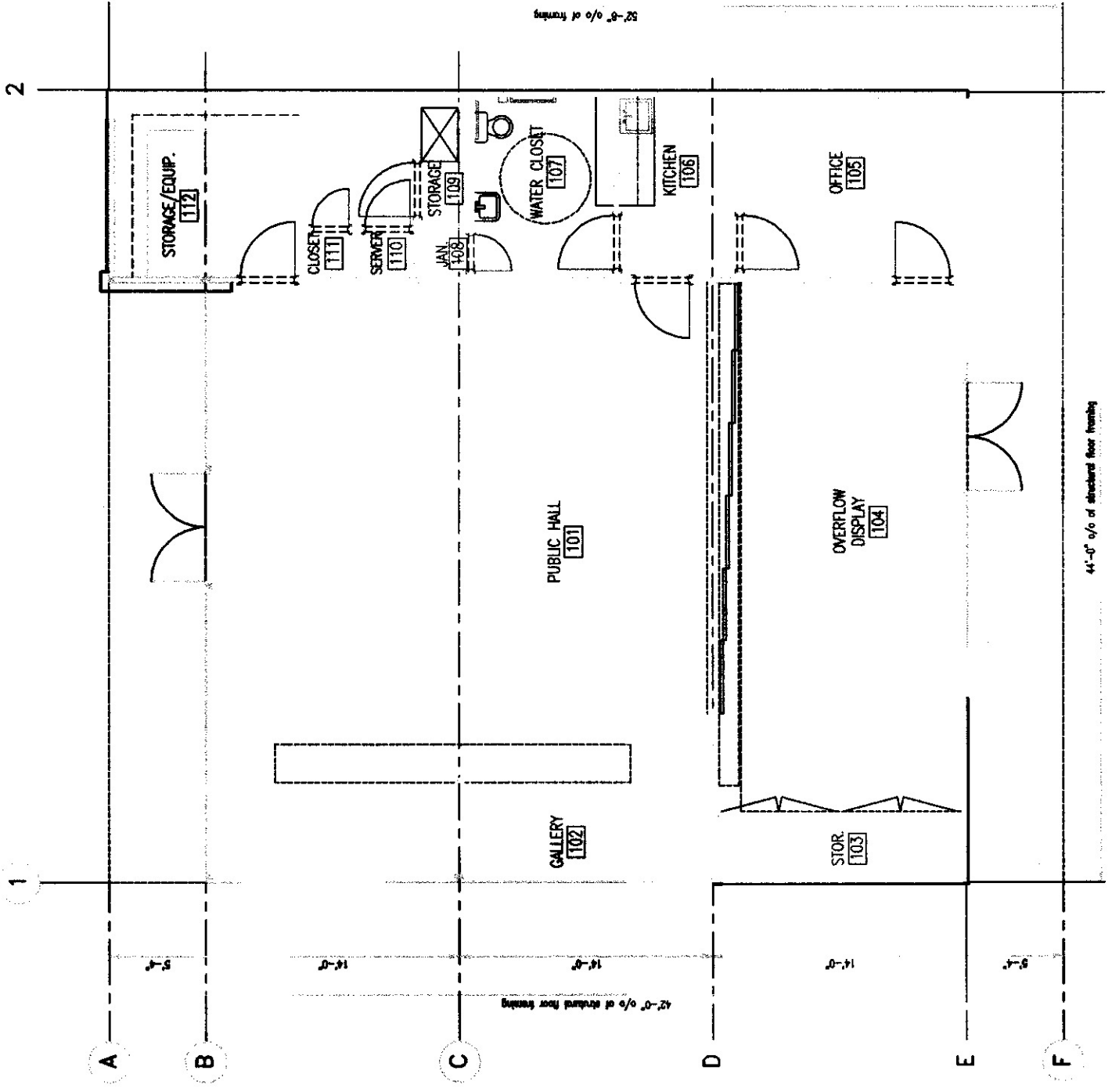

CLASIP PLAN
08.16.04