



Tim Hortons
Oakville, Ontario

Size: 20' x 27'6"
Square Footage: 560
Days to Complete: 43

Project Information

Construction:

This modular Tim Hortons building is fabricated with three floor sections, four canopy sections and two sets of column posts. It was designed to transport easily in three trailer loads. Construction is comprised of pre-poured concrete floors, structural steel and lumber.

Finishes:

The exterior cladding is aluminum with a metallic finish to provide a hi-tech appearance. The interior Customer Service Area features a non-slip flooring and durable maintenance free plastic laminate wall finish.

Millwork:

All store fixtures including donut racks, service counters, menu boards, etc. were manufactured and installed by NRB.

Electrical/Mechanical:

All selected features and fixtures were pre-installed at NRB's plant. Once set in place, the building was ready for final equipment installation and service connections.



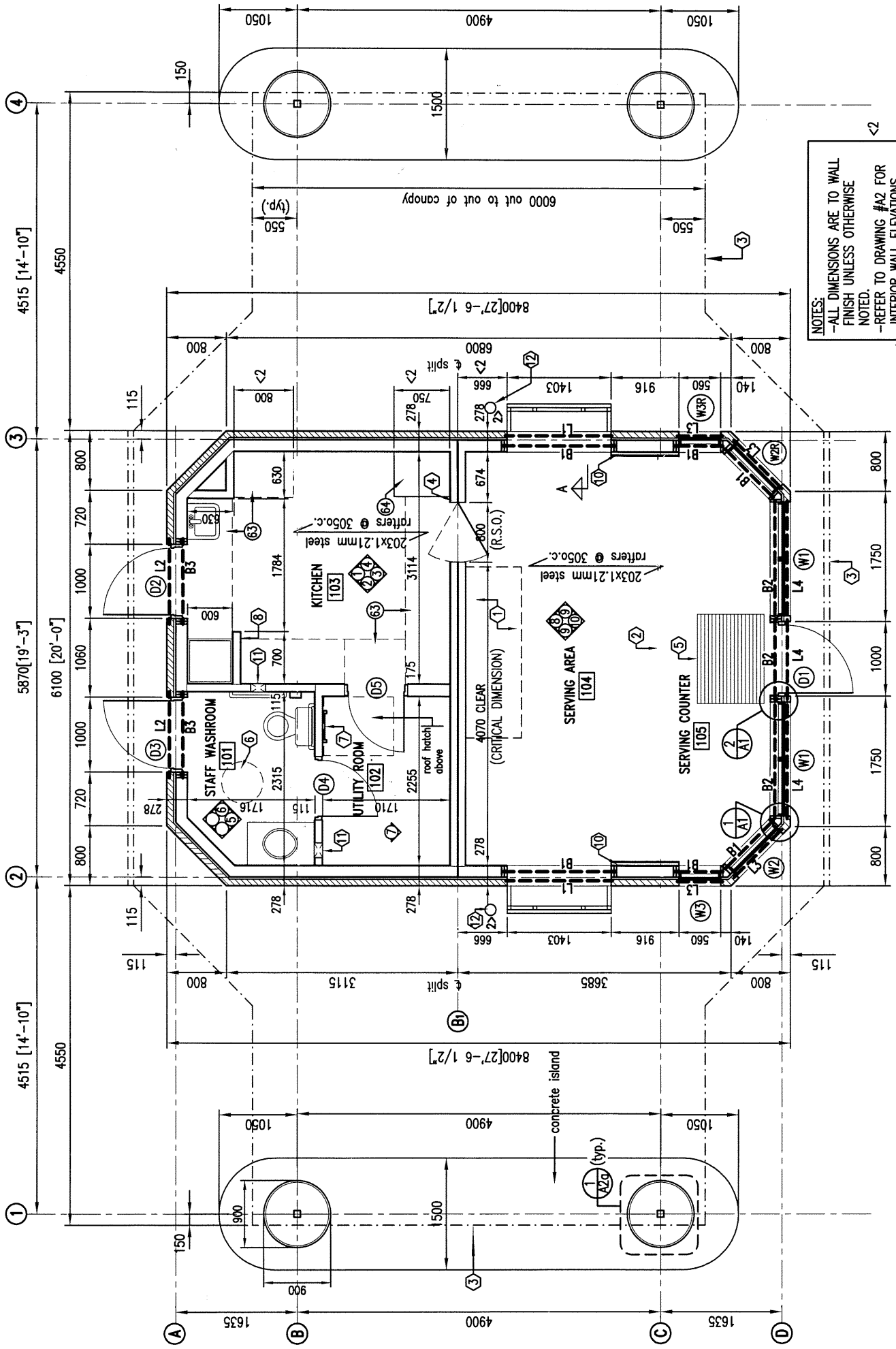

NOTES:
 -ALL DIMENSIONS ARE TO WALL FINISH UNLESS OTHERWISE NOTED.
 -REFER TO DRAWING #A2 FOR INTERIOR WALL ELEVATIONS.
 -REFER TO DRAWING #MK2 OF 2 FOR ITEMS #63 & #64.

FRONT

FLOOR PLAN
 1:50

#965012