



NRB

modular building specialists

RARITAN BAY MEDICAL CENTER

OLDBRIDGE, NEW JERSEY

Building Size: 9,800 square feet

Building Start: June 2001

Building Complete: October 2001

PROJECT PROFILE

Health Care

Project Profile # N05027

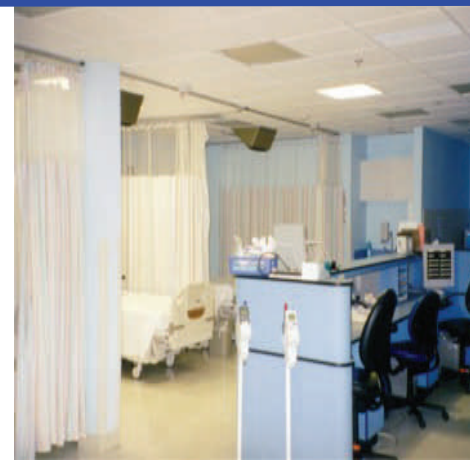

This addition was built off site completely as a 2 story structure to ensure perfect fit and alignment of all modules.

PROJECT OVERVIEW:

When a hospital in New Jersey had to expand their Emergency Patient Care Department, they looked to modular construction for the time sensitivity and reduced site disruption it offers. This two story addition was built off site with all features and finishes preinstalled, shipped in 22 sections and erected adjacent to the 4 story hospital facility. The first floor provides a Registration and Waiting Area, fast track and holding patient care areas with Nurse's station, X-ray reading, utility rooms and bathrooms as well as several offices. The second floor is open space, earmarked for future office expansion.

NO LIMITS... ONLY POSSIBILITIES

NRB INC., 115 South Service Road W., P.O. Box 129, Grimsby, Ontario L3M 4G3 Tel: 905.945.9622 Toll Free: 800.465.7594
NRB (USA), Inc., 440 Wenger Drive, Ephrata, PA 17522 Tel: 717.733.1794 Toll Free: 877.455.2160
Web: www.nrb-inc.com • Email: inquiries@nrb-inc.com



NRB

modular building specialists

RARITAN BAY MEDICAL CENTER OLDBRIDGE, NEW JERSEY

Building Size: 9,800 square feet

Building Start: June 2001

Building Complete: October 2001

PROJECT PROFILE

Health Care

Project Profile # N05027

FEATURES & BENEFITS:

- Steel framed post and beam construction, with concrete floors pre-poured at the plant.
- Fabricated completely as a 2 story structure to ensure perfect fit and alignment of all the modules both vertically and horizontally
- Interior finishes include drywall taped, filled and painted, 2' x 2' suspended acoustical ceiling and patterned vinyl composite tile floors.
- Exterior was finished to blend with the existing building including the brick and curtain wall system.

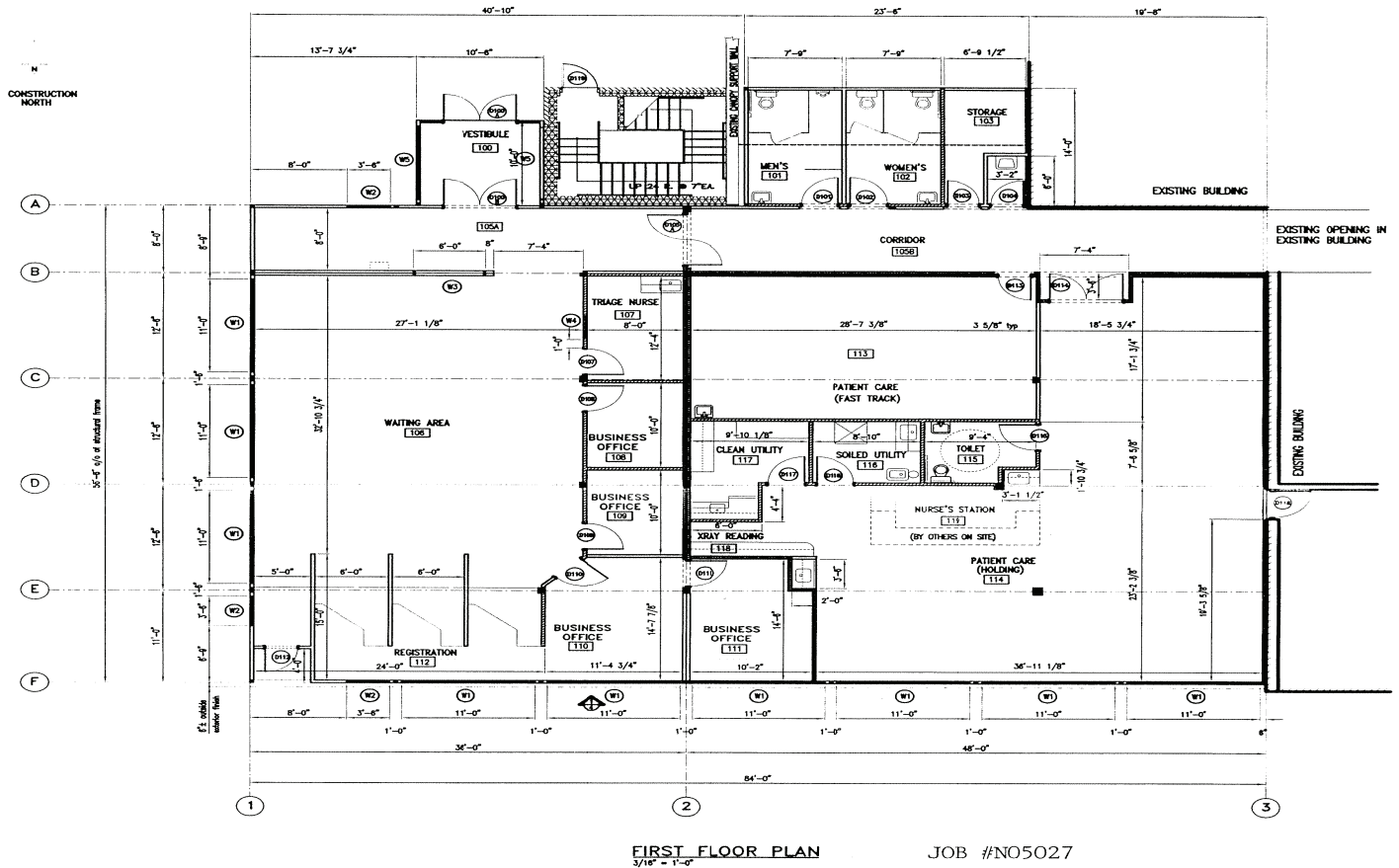

NO LIMITS... ONLY POSSIBILITIES