

KFC
Hamilton, Ontario



Project Information:

Square Footage:	3042 square feet plus basement
Production Start Date:	Feb 28, 1994
Date Shipped:	March 17, 1994

As speed of construction was a key requirement with this job, a modular structure was chosen.

In order to speed up the installation process, this building was fabricated using steel and concrete building technology—custom engineered for a fast site installation.

Architectural Features Include:

- Large exterior glazed windows
- Custom canopies
- Corporate colours and finishes throughout interior
- Drive-thru section
- Quarry tile floors and walls



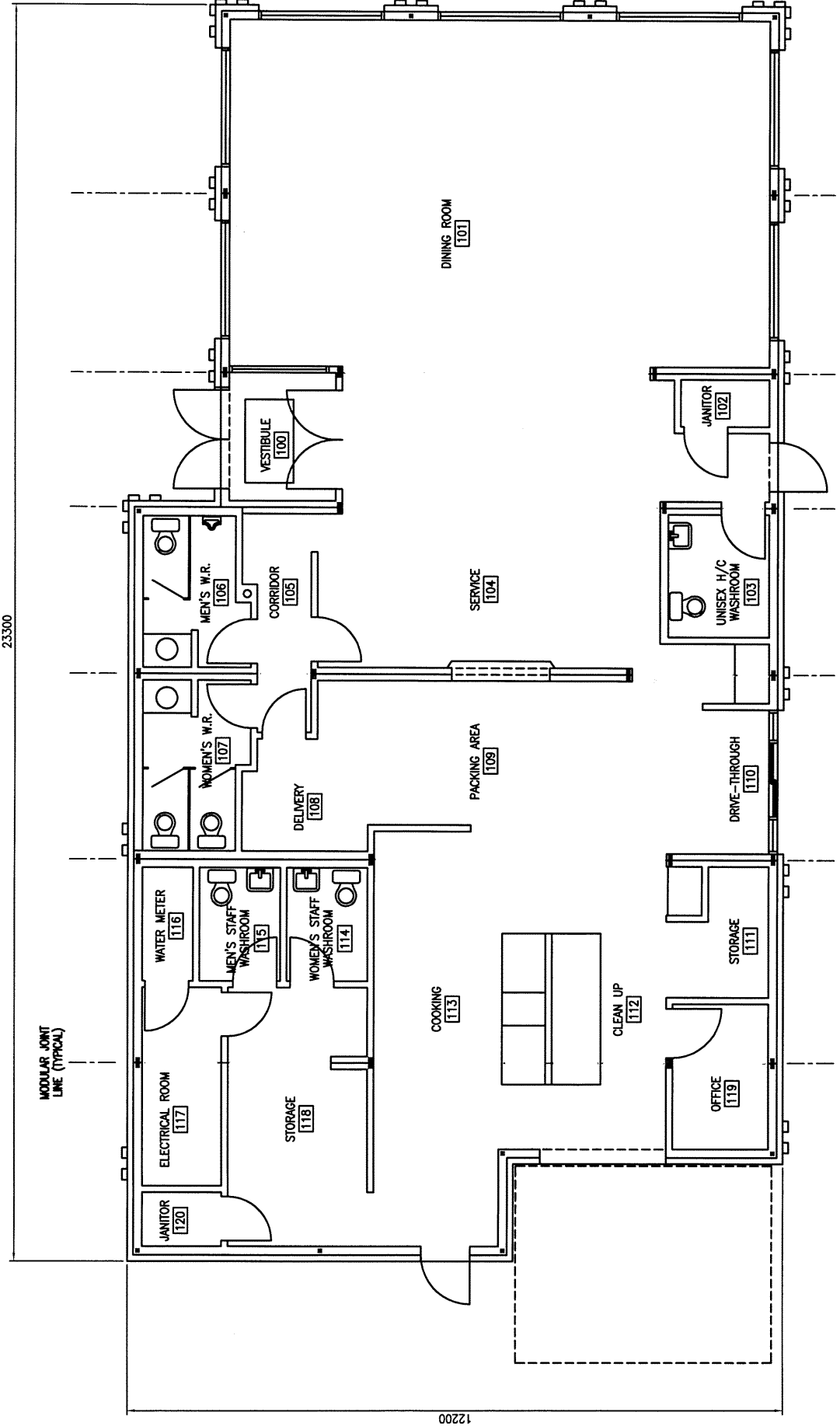

23300

MODULAR JOINT LINE (TYPICAL)

12200

PROPOSED MODULAR FLOOR PLAN
scale 1:100

#945003