



Glaxo Office Addition Mississauga, Ontario

Square Footage: 19,560
of Modules: 29
Days to Complete: 57
(From Production Start to Date Occupied)

Project Information

This temporary office space is located adjacent to the multi million dollar modern facility. The client required that their corporate image be maintained and that the exterior appearance blend in/compliment the existing structure. With the use of special vertical steel siding, a 36" wide steel fascia and large windows, this was achieved.



In an effort to keep costs down and still provide an architecturally pleasing appearance, the building was constructed using wood framing with a structural steel floor assembly for extended durability. The structural steel framed floor assembly allows it to be placed lower to the ground without potential deterioration of wood product due to moisture penetration. This also means that ramps may be shortened because of the lower elevations.

The transverse roof design, along with the identical module size and open concept design will allow for complete future flexibility in re-use and re-configuration.

NRB Modular Buildings. Ready when you are.

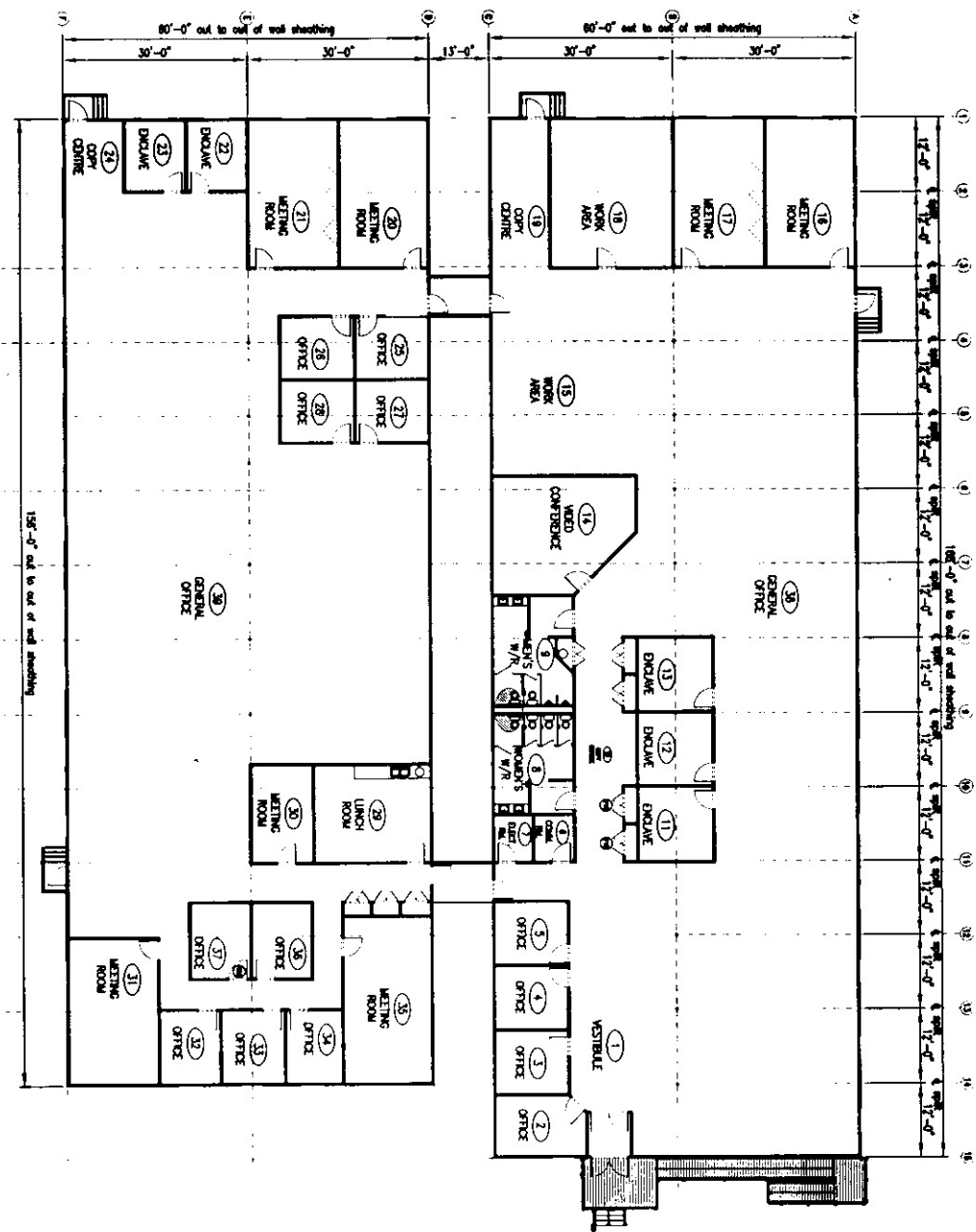

FLOOR PLAN

Job #N04008